

Klapprahmen Softpro

Klapprahmen Smartpro

①

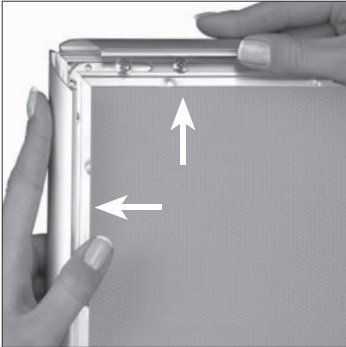

- Open all profiles upwards.
- Alle Profile in der Pfeilrichtung öffnen.

②

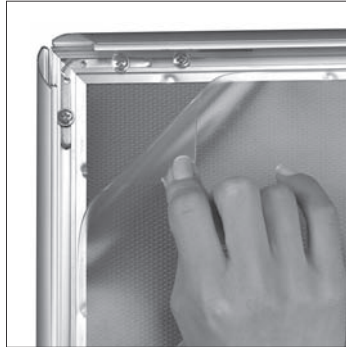

- Take-off the anti-reflex cover.
- Antireflex -Schutzfolie abheben.

③

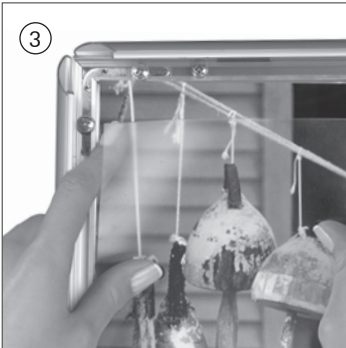

- Place the poster in.
- Poster einlegen.

④



- After placing the cover back on the poster, close the profiles downwards.
- Antireflex-Schutzfolie auf Poster legen und die Seitenprofile in Pfeilrichtung zuklappen.